

# ORIGINAL PLANS

By  
Brad Clark

**Pressure Treated Rocking Chair**



### Arm Rests

- Planning to cut this out of a 2x4 then rip in two

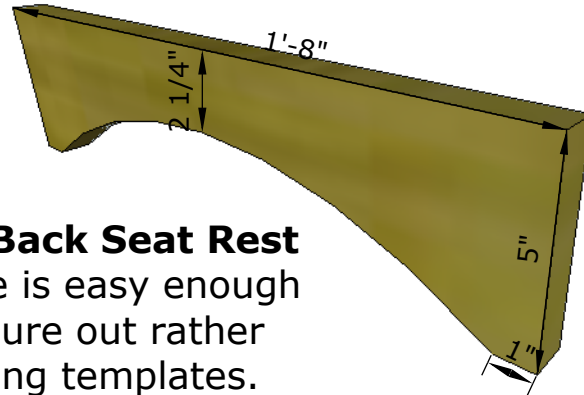

### Front/Back Seat Rest

This one is easy enough to measure out rather than using templates.

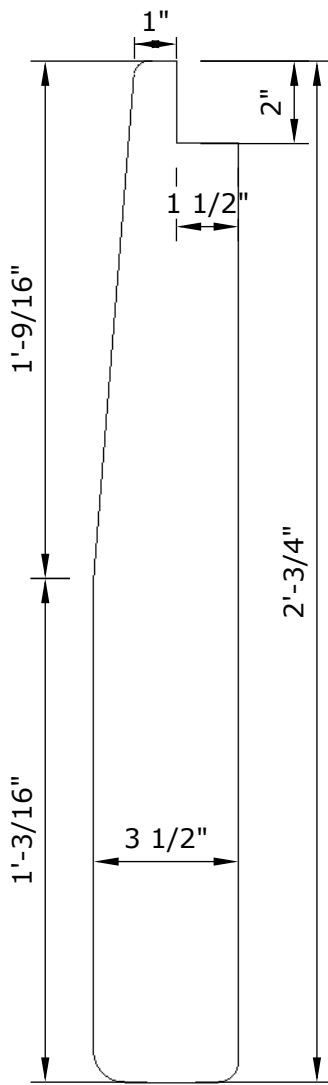

**Back Rest Slats:** You will need 6 slats ripped from 2 by material that will be 2'7" long by 3/8" thick.



**Seat Slats:** You will need 9 slats ripped from 2 by material that will be 1'9" long by 3/8" thick

**Bottom Supports:** The supports are cut from Deck board 5/4 material to make 1" by 1" square stock.

**Front/Back:** 1'8"

**Left/Right:** 1'6"



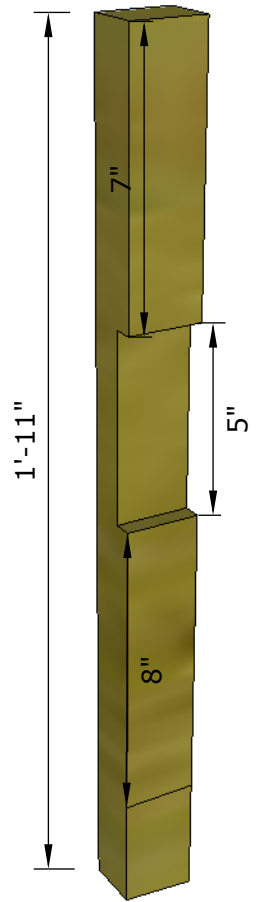
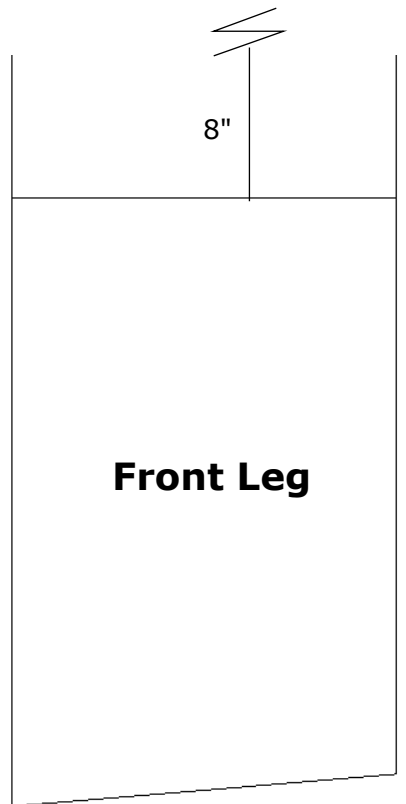
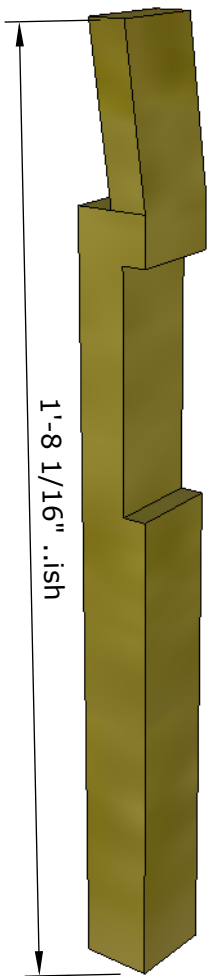
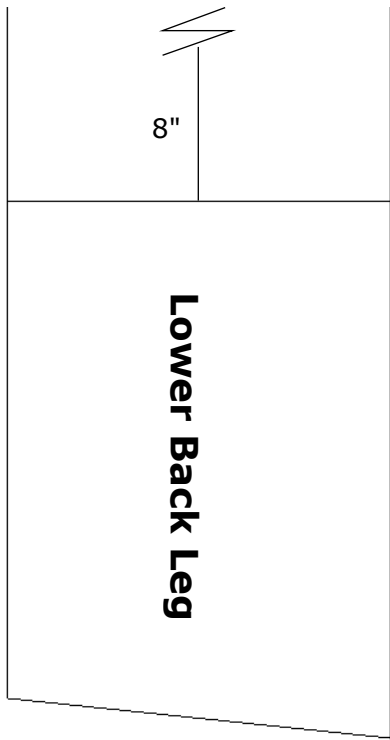
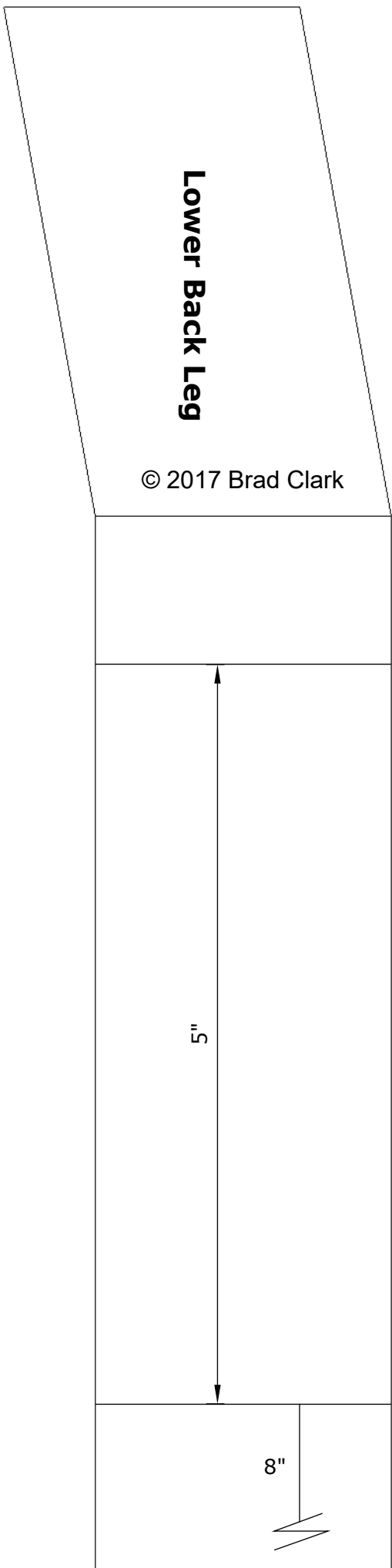

**Rocker Template**

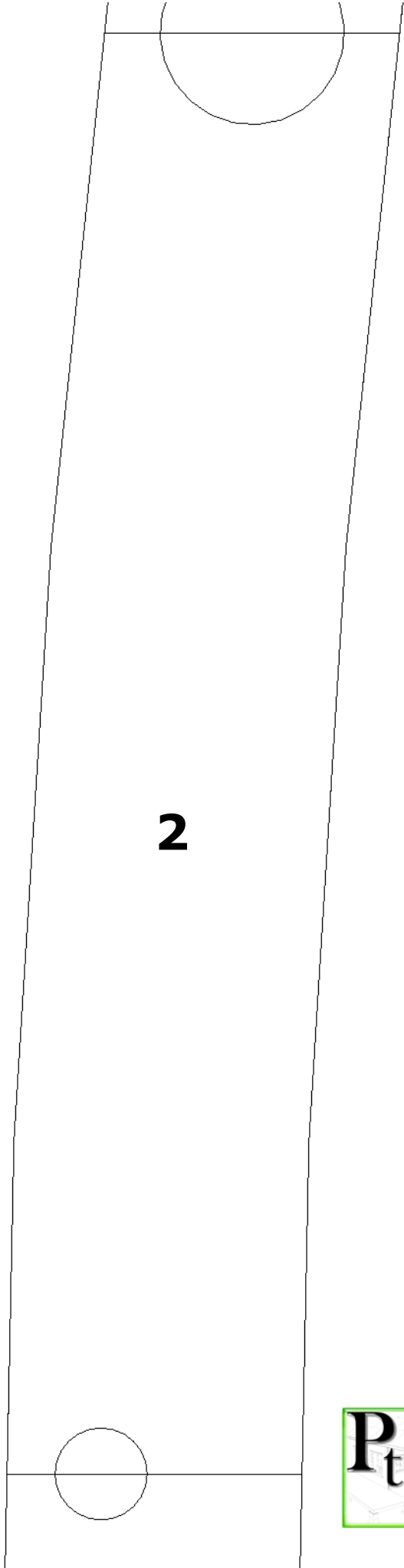
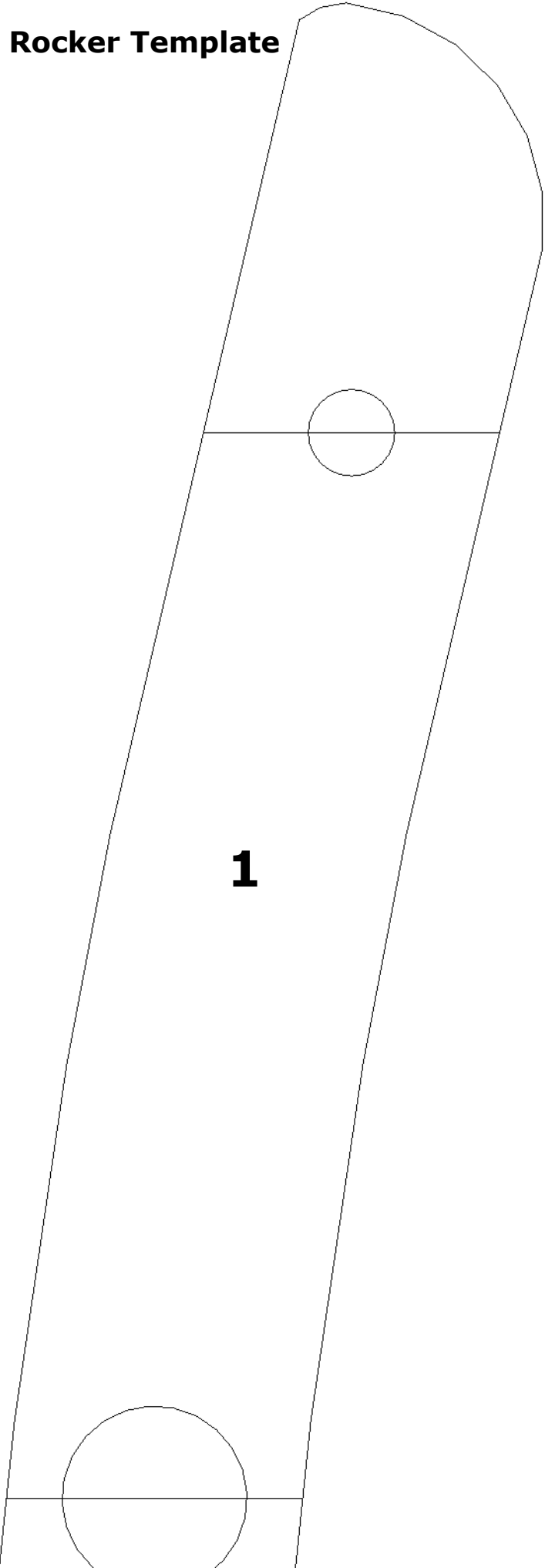

**Rocker Template**

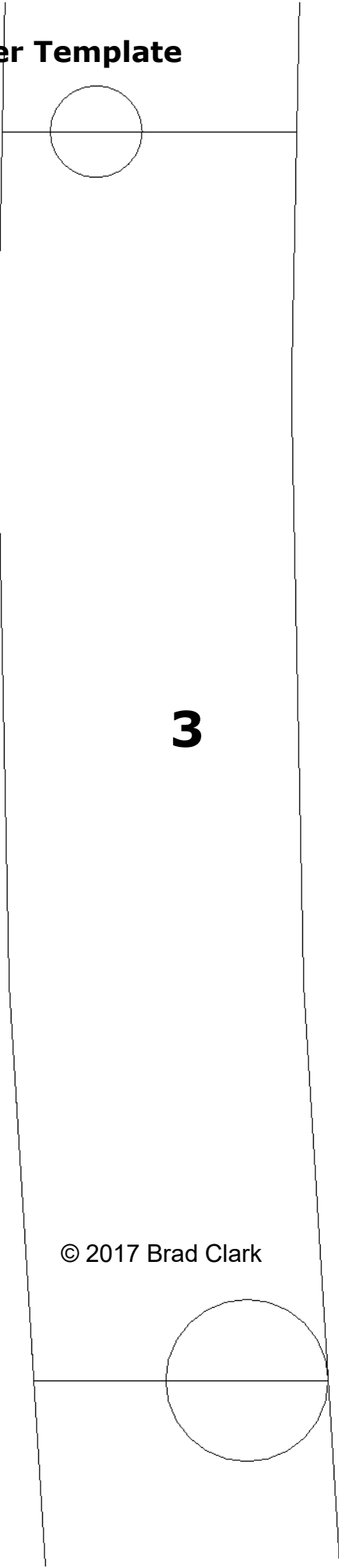

**3**

© 2017 Brad Clark

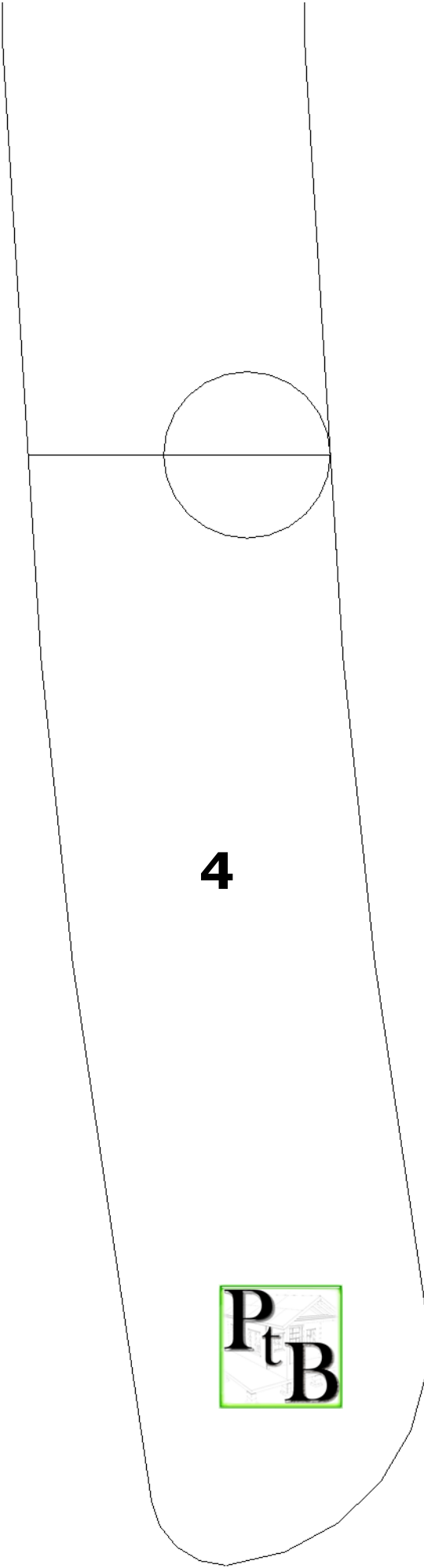

**4**



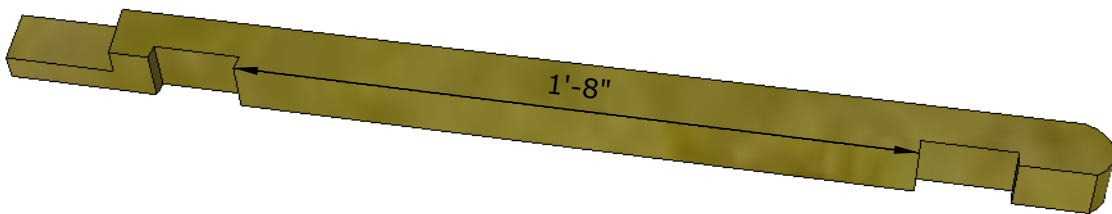
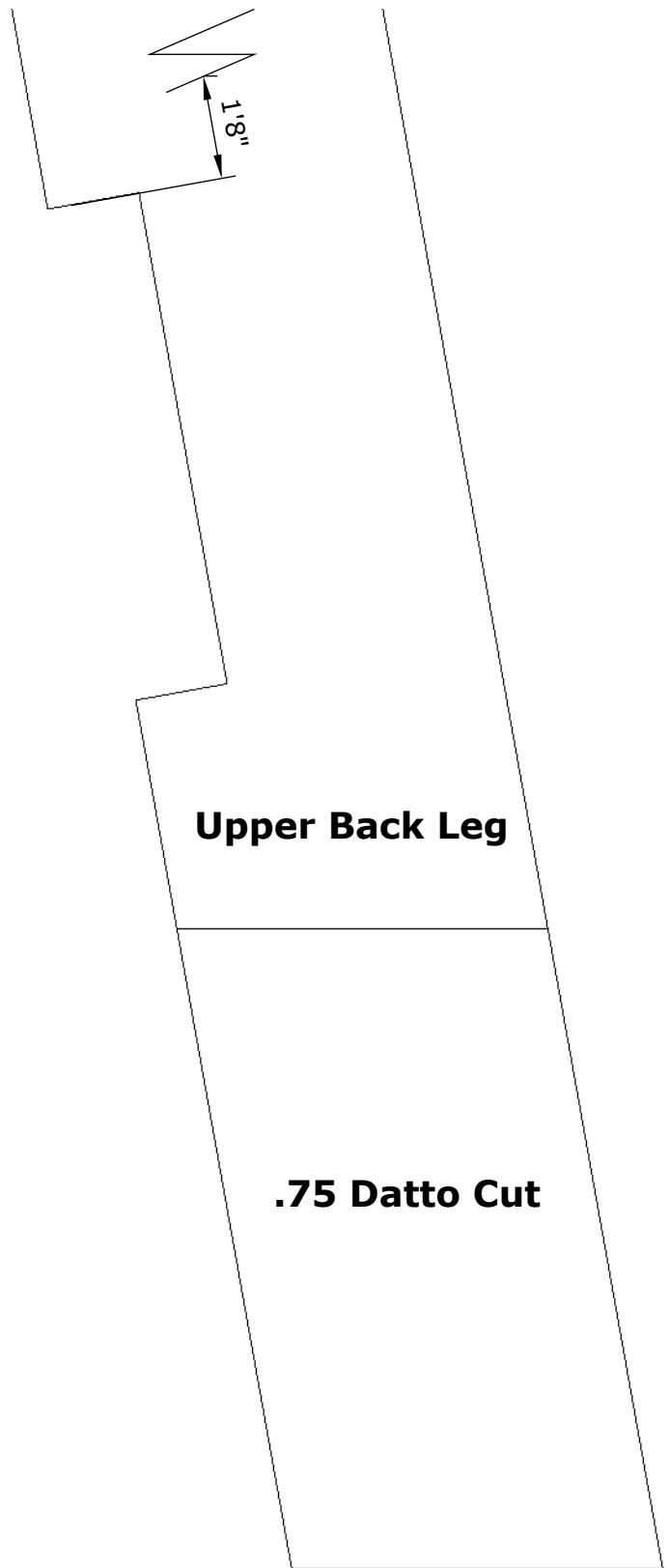
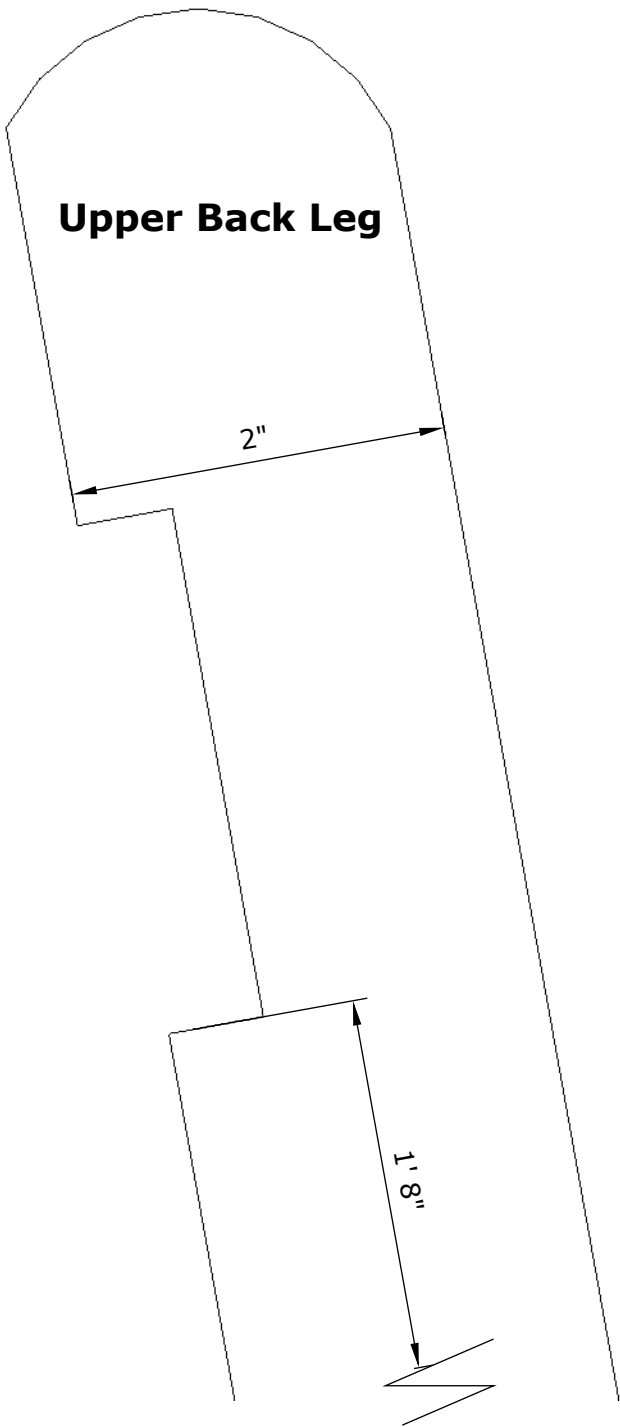

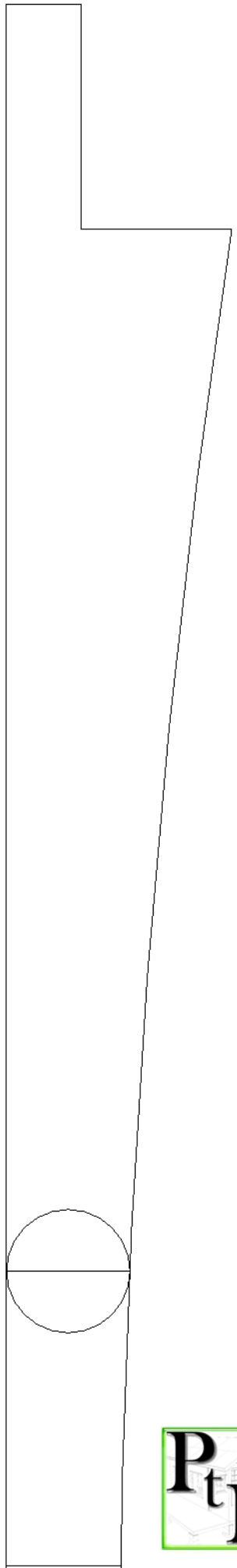

**Back Rest**

This is the end view of a 2x6. cut it out then split it in two to make the top and bottom back rest.

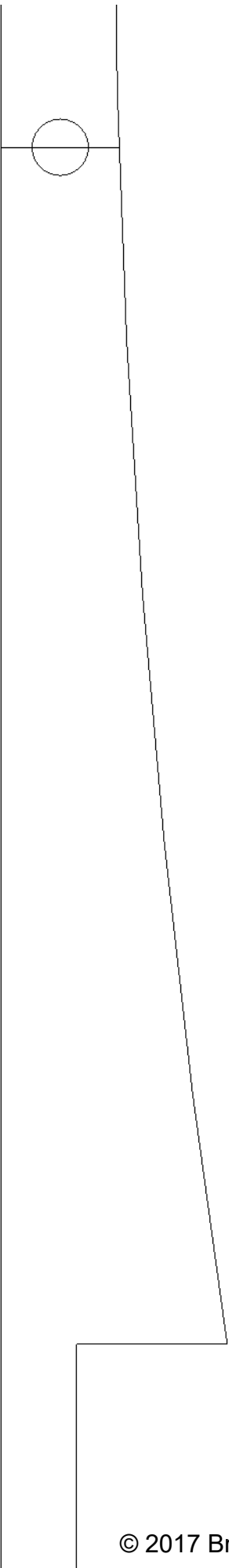
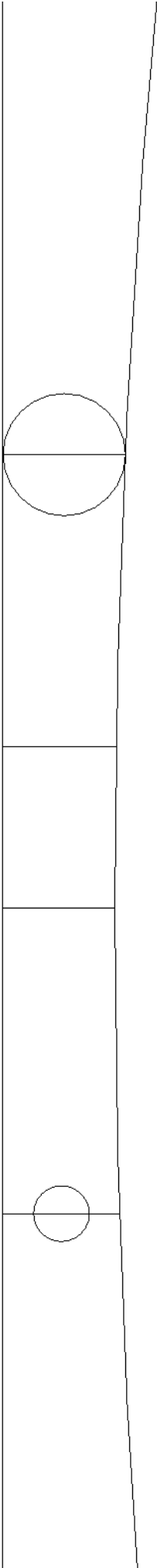

# Left/Right Seat Rest

**1**

**2**

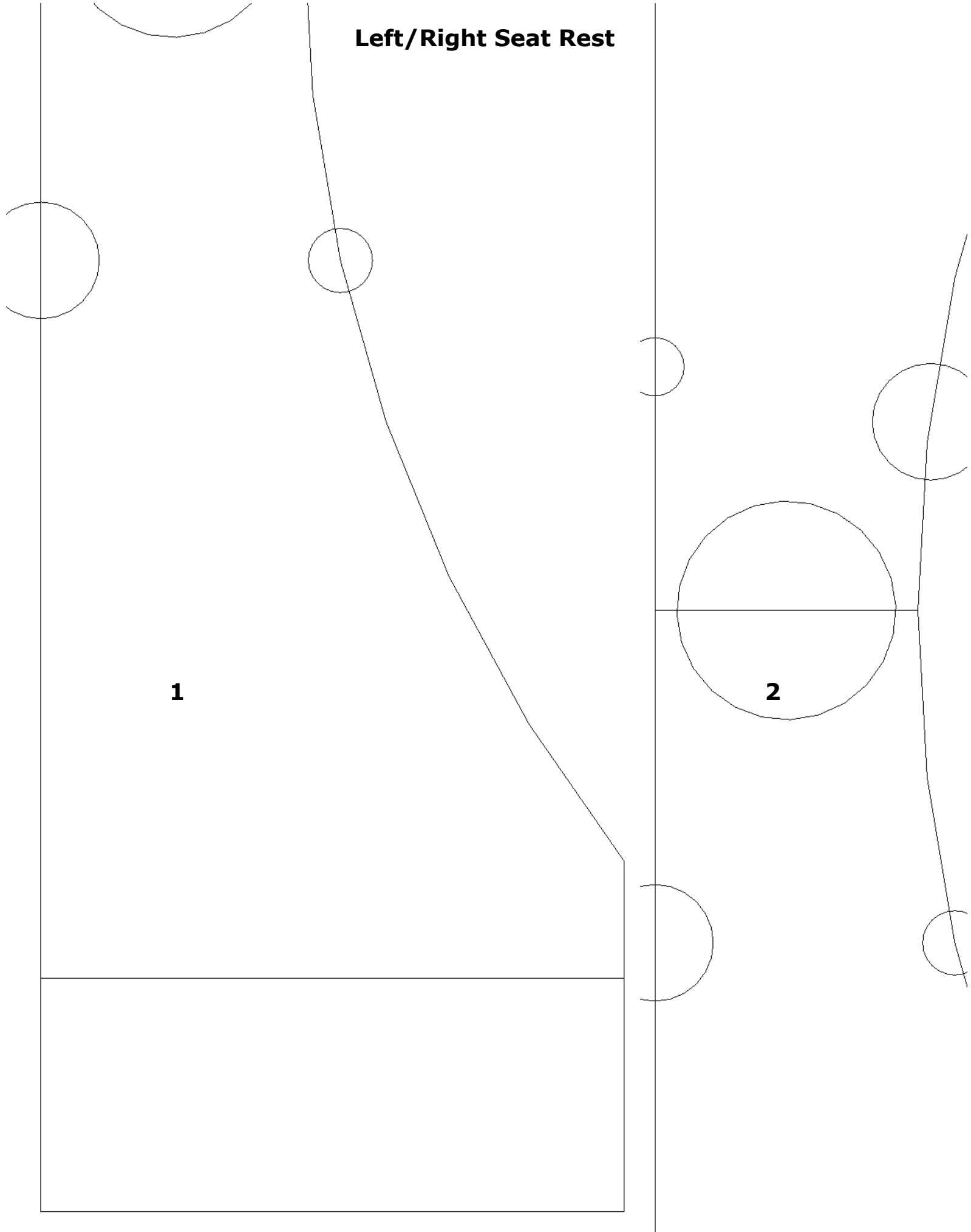

**Left/Right Seat Rest**

2"

5"

**3**

