

Original Plans **By** Brad Clark

1/6 Playscale Nightstand, Cottage Style



©2012 Brad Clark

The purchase of these plans does not transfer any copyright or other ownership interest in the plans, the design, or the finished project to the buyer. Buyer may neither reproduce the plans for sale nor offer for sale any copies of the finished project.



TEMPLATE A

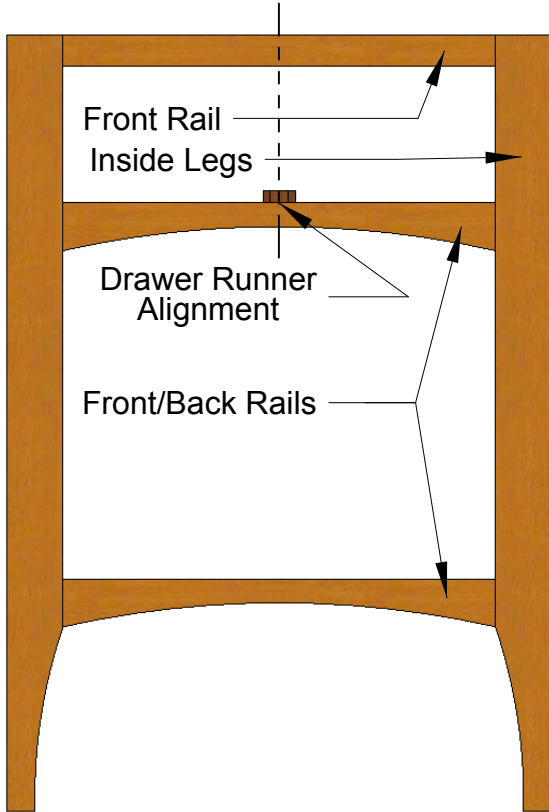

Use TEMPLATE A to build the Front and Back Frame. When assembling the front frame, transfer the drawer runner location by drawing a center mark on to the front rail. When assembling the back frame, align the back apron flush with the top of the legs before gluing. Transfer the centerline mark onto the back apron, this will be used later to align the drawer runner.

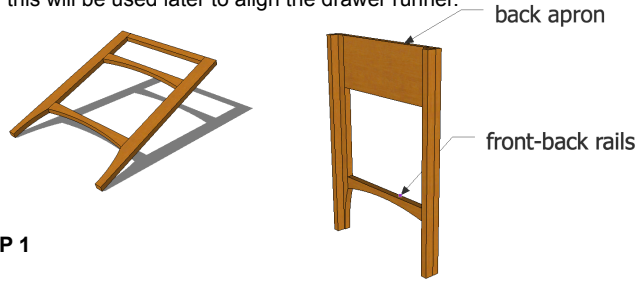

STEP 1

Glue the outside legs to the inside legs. One side of the outside leg is a little larger than the other. Ensure the narrowest part of the outside leg is glued to the inside leg. Do this for both the front and back leg posts.

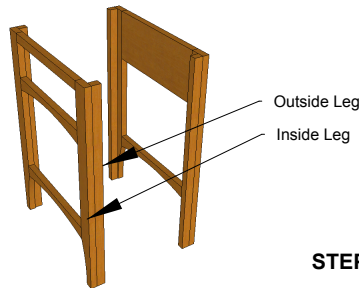

STEP 2

Glue the top support frame rail and drawer frame front/back rails as pictured. Make sure the drawer frame is flush with the bottom of the back apron and flush with the top front rail.

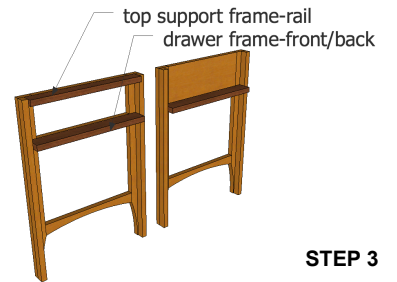

STEP 3

TEMPLATE B

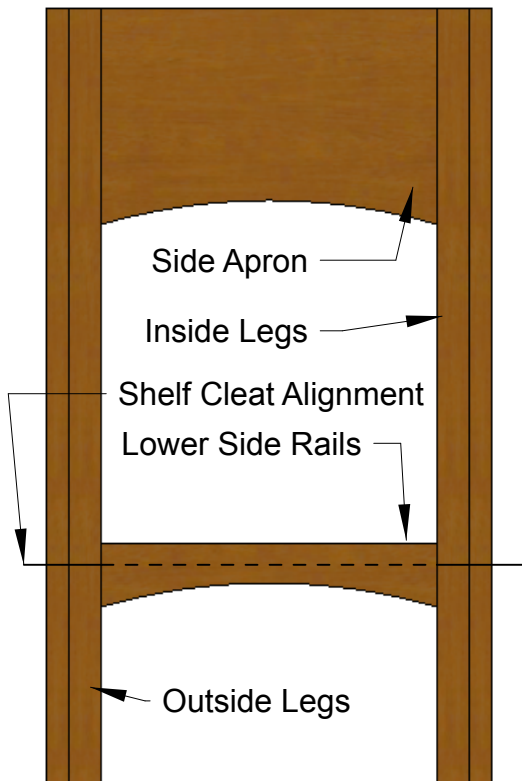

Using TEMPLATE B, transfer alignment marks to the inside legs for the shelf cleat, then attach side apron and lower side rails to front and back frame. Use a square or block of wood to ensure the sides are straight up and down. Do this for both sides. Cut a 1/16 x 1/16 x 2" stick of wood to use as the shelf cleat. Align the top of the shelf cleat with the marks made earlier in this step and secure with glue.

STEP 4

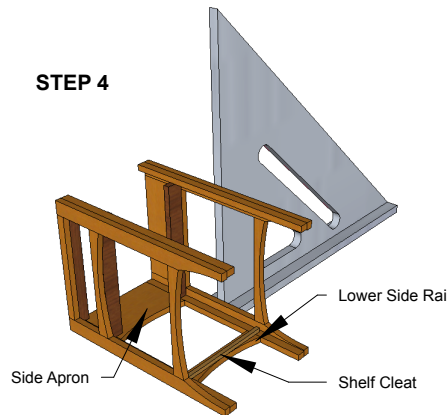

Fit in the Top Support Frame Rails and Drawer Frame Rails. Use the center marks created during step 1 to align the Drawer Runner. Then fit in the shelf boards and glue to the top of the shelf cleat.



STEP 5

Flip nightstand upside down and center onto the top. There should be approximately 1/4" of space on all four sides of the top. Glue in place.



STEP 6

2 DAYS TALK

Questions or comments, feel free to email me directly:
baclarkservices@gmail.com

©2012 Brad Clark

TEMPLATE C

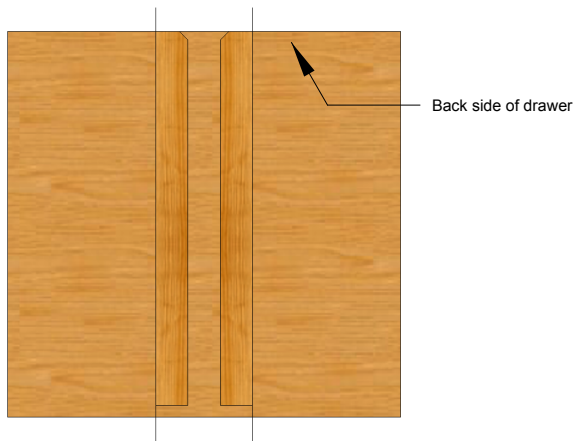

Use TEMPLATE C to transfer drawer guide alignment marks to the drawer bottom then glue drawer guides to drawer bottom as pictured.

STEP 7

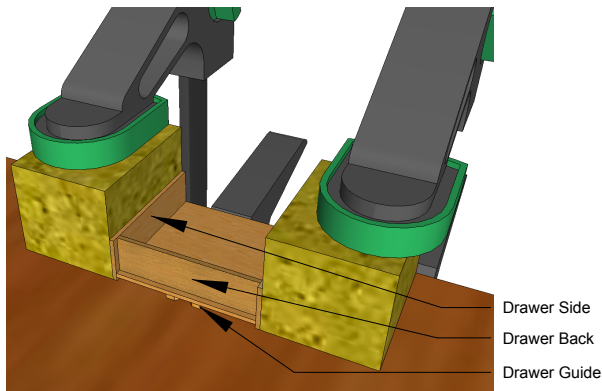

Place the drawer bottom on a flat work surface. Use the drawer guides as a reference to ensure the drawer bottom is flat. Using scrap wood blocks sandwich the drawer sides and drawer back in place. Ensure the drawer sides are flat on the work surface. Align the drawer back slightly forward from the back of drawer as pictured. Clamp in place and apply glue.

STEP 8

TEMPLATE D



Use TEMPLATE D to align the drawer with the drawer front. Glue in place.

STEP 9

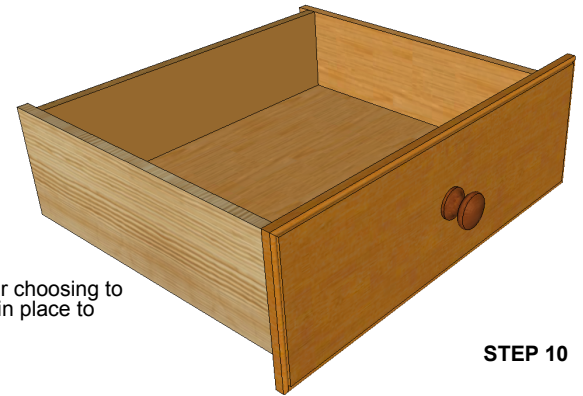

Center a door knob of your choosing to the drawer front and glue in place to complete the drawer.

STEP 10

Tips:

1. Apply clear packing tape over templates and on your work surface before glueing parts. If you don't want to put packing tape on your work surface use wax paper instead. This will keep the assembly you are working on from sticking to the template or work surface and also keep your work surface clean from any glue spillage.
2. Carefully use a very sharp razor knife and straight edge to cut out the cut sheets or very carefully cut along the line with scissors. A nice straight cut helps with aligning the cut sheet to the wood sheet.
3. Use a glue-stick to affix the cut sheets to the wood sheets. Ensure the edges are coated fairly well and use lots of small figure 8 motions to cover the rest of the cut sheet.
4. When cutting out parts attempt to leave the line and not cut it away. It is better to have more wood that you can sand down or trim with a razor knife than a work piece that is too small.
5. Each work piece has to be sanded. I find it best to use a flat surface to sand the parts that have straight edges, this way any imperfections that may have occurred when cutting out the parts can usually be sanded out. This technique leaves good straight work pieces.

MATERIAL LIST:

QTY	MATERIAL	NOTES
1	sheet 1/8 X 3 X 24	Basswood or other hardwoods suggested
1	sheet 1/16 x 2 x 12	Basswood or other hardwoods suggested
1	1/16" x 1/16" x 4"	Square Stick--Basswood suggested
1	your choice	Knob

1/8 x 3 x 24 wood sheet Cut Sheet A-2

